



Emergency Backup Power Supply Replacement Instructions

For the 2GIG system

- 1) Call **1 800 653-9111** to have your system placed on test.
- 2) Confirm you received the correct backup power supply (battery) from ADT (Picture 1).
- 3) Locate the panel's power supply and unplug (Picture 2).
- 4) Remove the screw at the top of the panel (Picture 3).
- 5) Press the plastic tabs located on top of the unit to remove panel (Picture 3). Use the strap to hang panel on the mounting back (Picture 4).
- 6) Remove the battery from the compartment, replace with new battery (Picture 4).
- 7) Lift and close the panel; it will click shut. Insert the screw back on at the top of the panel.
- 8) Plug in the panel's power supply after 1 minute.
- 9) Test system after replacing battery.



Take your old emergency backup power supply to the nearest recycling centre.



Emergency backup power supply

(Picture 1)



Power supply

(Picture 2)



(Picture 3)

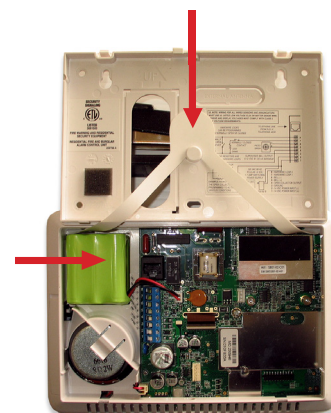

(Picture 4)